

# Basler IP Fixed Dome Cameras

NETWORK CAMERAS

 **ALAVA**  
INGENIEROS

[www.alavaingenieros.com](http://www.alavaingenieros.com)

Madrid 91 567 97 00

Barcelona 93 459 42 50



- Premium image quality
- CCD and CMOS sensors
- HD, Full HD
- Multi-streaming and multi-encoding
- MJPEG, MPEG-4, H.264

**BASLER**  
the power of sight

# OVERVIEW

## Basler IP Fixed Dome Cameras

Basler's network camera portfolio includes robust, easy-to-install network cameras with dome housings for your network video applications outdoors and under tough indoor conditions. Basler IP Fixed Dome Cameras will impress you with their exceptional image quality and light sensitivity. We also offer dome camera models with integrated audio and auto focus functionalities.

With their built-in heater and fan, Basler's outdoor dome cameras work at extreme operating temperatures from -40 °C to +50 °C (-40 °F to +122 °F). Basler's dome cameras are especially energy efficient. All camera functions, including the fan and heater, can be powered using standard PoE (Power over Ethernet IEEE 802.3af Class 0). Their built-in microSDHC card slot can be used for local file storage of up to 32 MB of data.

Basler IP Cameras are used in a variety of applications, ranging from building surveillance, bank and casino security, goods protection, and traffic applications. Does your project require a special camera solution? Please contact us and we'll help you find the right fit for your application!



# TECHNICAL DETAILS

## Specifications



| CMOS Sensor Cameras     | BIP2-D1920c-dn (Indoor)   | BIP2-D1920c-dn (Indoor, AF) |        |
|-------------------------|---|-----------------------------|--------|
| Image Sensor            | Progressive Scan CMOS, rolling shutter  |                             |        |
| Effective Pixels        | 1920 (H) x 1440 (V)   |                             |        |
| Frame Rate (max.)       | MJPEG   | MPEG-4                      | H.264  |
| Full Resolution:        | 20 fps  | 20 fps                      | 20 fps |
| Full HD (1920 x 1080):  | 30 fps  | 30 fps                      | 30 fps |
| Pixel Size              | 2.2 $\mu\text{m}$ x 2.2 $\mu\text{m}$   |                             |        |
| Minimum Illumination    | Color: 0.88 lux (F1.3/33ms), Day/Night: 0.15 lux (F1.3/33ms)  |                             |        |
| Lens                    | Varifocal 2.8-10 mm, F1.3, DC iris, horizontal angle of view 25°-88°, removable IR-cut filter for day/night function  |                             |        |
| Auto Focus              | No  | Yes                         |        |
| Camera Angle Adjustment | Pan: 360°, tilt: 120°, rotation: $\pm 180^\circ$  |                             |        |
| Image Settings          | Automatic gain, exposure area, backlight compensation, white balance, 180° image rotation, mirroring of images, anti-flicker, electronic PTZ via AOI (API), text overlay, privacy masks, motion detection |                             |        |
| Resolution              | From 160 x 120 to 1920 x 1440 (free scaling), 4:3, 16:9, multiple Areas of Interest (AOIs)  |                             |        |
| Video Compression       | Motion JPEG: Multiple compression levels<br>MPEG-4: SP (Level 3)<br>H.264 (MPEG-4 AVC): Baseline and high profile (levels up to 5.0)  |                             |        |
| Video Streaming         | Dual streaming for MJPEG, H.264, or MPEG-4; VBR and CBR for MJPEG and MPEG-4<br>VBR, CBR, and CVBR for H.264; multicast and unicast   |                             |        |
| Audio                   | Bidirectional half-duplex audio streaming; mic-in/line-in, line-out; G.711  |                             |        |
| Alarm Management        | Ring buffer for pre and post alarm images, microSDHC card slot for local storage<br>Events triggered by motion detection or external input, image upload over FTP, e-mail, or HTTP                        |                             |        |
| Protocols               | TCP/IP, HTTP, UDP, FTP, ICMP, ARP, DHCP, NTP, RTP, RTSP, RTCP, SMTP, IGMP, ZEROCONF, QoS Layer 3, SNMP  |                             |        |
| Processor/Memory        | Multimedia Video Processor, FPGA, 256 MB RAM, 64 MB Flash   |                             |        |
| Power                   | PoE (Power over Ethernet IEEE 802.3af Class 2)<br>Power consumption typ. 5.5 W at 12 VDC  |                             |        |
| Connectors              | RJ-45 connector for 10/100 BASE-T Ethernet, full or half duplex<br>Push-in terminal for digital I/O and RS-485/422  |                             |        |
| Operating Conditions    | -10 °C to 50 °C (14 °F to 122 °F), <90% relative humidity (non-condensing)<br>Starting temperature: 0 °C to 50 °C (32 °F to 122 °F)   |                             |        |
| Standards               | DIN EN 50130-4, FCC Class A, CE, RoHS, ONVIF  |                             |        |
| Housing                 | $\varnothing$ 148 mm x 122 mm ( $\varnothing$ 5.83" x 4.8") plastic chassis with polycarbonate dome bubble  |                             |        |
| Weight                  | ~0.6 kg   |                             |        |

Specifications are subject to change without prior notice.

## Dimensions in mm (inch)

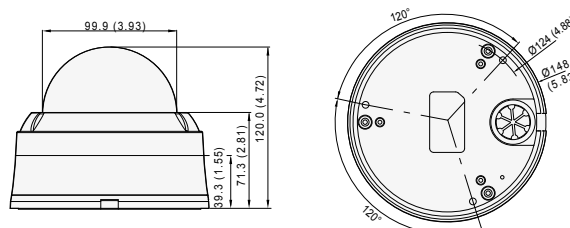

# TECHNICAL DETAILS

## Specifications



| CMOS Sensor Cameras     | BIP2-D1920c-dn (Outdoor)  |        | BIP2-D1920c-dn (Outdoor, AF) |
|-------------------------|---|--------|------------------------------|
| Image Sensor            | Progressive Scan CMOS, rolling shutter  |        |                              |
| Effective Pixels        | 1920 (H) x 1440 (V)   |        |                              |
| Frame Rate (max.)       | MJPEG   | MPEG-4 | H.264                        |
| Full Resolution:        | 20 fps  | 20 fps | 20 fps                       |
| Full HD (1920 x 1080):  | 30 fps  | 30 fps | 30 fps                       |
| Pixel Size              | 2.2 $\mu\text{m}$ x 2.2 $\mu\text{m}$   |        |                              |
| Minimum Illumination    | Color: 0.88 lux (F1.3/33ms), Day/Night: 0.15 lux (F1.3/33ms)  |        |                              |
| Lens                    | Varifocal 2.8-10 mm, F1.3, DC iris, horizontal angle of view 25°-88°, removable IR-cut filter for day/night function  |        |                              |
| Auto Focus              | No  | Yes    |                              |
| Camera Angle Adjustment | Pan: 360°, tilt: 120°, rotation: $\pm 180^\circ$  |        |                              |
| Image Settings          | Automatic gain, exposure area, backlight compensation, white balance, 180° image rotation, mirroring of images, anti-flicker, electronic PTZ via AOI (API), text overlay, privacy masks, motion detection |        |                              |
| Resolution              | From 160 x 120 to 1920 x 1440 (free scaling), 4:3, 16:9, multiple Areas of Interest (AOIs)  |        |                              |
| Video Compression       | Motion JPEG: Multiple compression levels<br>MPEG-4: SP (Level 3)<br>H.264 (MPEG-4 AVC): Baseline and high profile (levels up to 5.0)  |        |                              |
| Video Streaming         | Dual streaming for MJPEG, H.264, or MPEG-4; VBR and CBR for MJPEG and MPEG-4<br>VBR, CBR, and CVBR for H.264; multicast and unicast   |        |                              |
| Audio                   | Bidirectional half-duplex audio streaming; mic-in/line-in, line-out; G.711  |        |                              |
| Alarm Management        | Ring buffer for pre and post alarm images, microSDHC card slot for local storage<br>Events triggered by motion detection or external input, image upload over FTP, e-mail, or HTTP                        |        |                              |
| Protocols               | TCP/IP, HTTP, UDP, FTP, ICMP, ARP, DHCP, NTP, RTP, RTSP, RTCP, SMTP, IGMP, ZEROCONF, QoS Layer 3, SNMP  |        |                              |
| Processor/Memory        | Multimedia Video Processor, FPGA, 256 MB RAM, 64 MB Flash   |        |                              |
| Power                   | PoE (Power over Ethernet IEEE 802.3af Class 0) or 12 to 24 VDC<br>Power consumption typ. 5.5 W at 12 VDC (excl. heater)   |        |                              |
| Connectors              | RJ-45 connector for 10/100 BASE-T Ethernet, full or half duplex<br>Push-in terminal for DC power, digital I/O, and RS-485/422   |        |                              |
| Operating Conditions    | -40 °C to 50 °C (-40 °F to 122 °F), <90% relative humidity (non-condensing)<br>Starting temperature: -40 °C to 50 °C (-40 °F to 122 °F)   |        |                              |
| Standards               | DIN EN 50130-4, FCC Class A, CE, RoHS, ONVIF  |        |                              |
| Housing                 | $\varnothing$ 148 mm x 122 mm ( $\varnothing$ 5.83" x 4.8") vandal-proof aluminum chassis<br>with polycarbonate dome bubble, IP66   |        |                              |
| Weight                  | -1.0 kg   |        |                              |

Specifications are subject to change without prior notice.

## Dimensions in mm (inch)

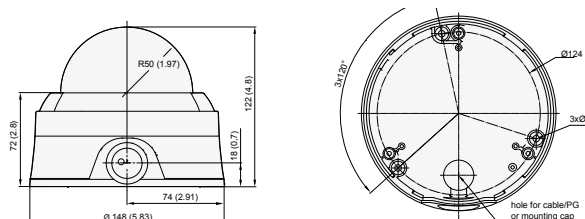

# TECHNICAL DETAILS

## Specifications



| CCD Sensor Cameras      | BIP2-D1000c-dn  | BIP2-D1300c-dn   |                 |
|-------------------------|---|--|-----------------|
| Image Sensor            | Progressive Scan CCD, global shutter  |  |                 |
| Effective Pixels        | 1024 (H) x 768 (V)  | 1280 (H) x 960 (V)   |                 |
| Frame Rate (max.)       | MJPEG<br>30 fps   | MPEG-4<br>30 fps   | H.264<br>30 fps |
| Full Resolution:        |   |  |                 |
| Pixel Size              | 4.65 µm x 4.65 µm   |  |                 |
| Minimum Illumination    | Color: 0.53 lux (F1.3/33ms),<br>Day/Night: 0.14 lux (F1.3/33ms)   |  |                 |
| Lens                    | Varifocal 2.8-10 mm, F1.3, DC iris, horizontal angle of view 28°-100°,<br>removable IR-cut filter for day/night function  |  |                 |
| Camera Angle Adjustment | Pan: 360°, tilt: 120°, rotation: ±180°  |  |                 |
| Image Settings          | Automatic gain, exposure area, backlight compensation, white balance, 180° image rotation,<br>mirroring of images, anti-flicker, electronic PTZ via AOI (API), text overlay, privacy masks,<br>motion detection |  |                 |
| Resolution              | From 160 x 120 to 1024 x 768 (free scaling),<br>4:3, 16:9, multiple Areas of Interest (AOIs)  | From 160 x 120 to 1280 x 960 (free scaling),<br>4:3, 16:9, multiple Areas of Interest (AOIs) |                 |
| Video Compression       | Motion JPEG: Multiple compression levels<br>MPEG-4: SP (Level 3)<br>H.264 (MPEG-4 AVC): Baseline and high Profile (levels up to 5.0)  |  |                 |
| Video Streaming         | Multi-encoding and multi-streaming for MJPEG, H.264, and MPEG-4<br>VBR and CBR for MJPEG and MPEG-4; VBR, CBR, and CVBR for H.264; multicast and unicast  |  |                 |
| Audio                   | Bidirectional half-duplex audio streaming; mic-in/line-in, line-out; G.711  |  |                 |
| Alarm Management        | Ring buffer for pre and post alarm images, microSDHC card slot for local storage<br>Events triggered by motion detection or external input (real-time trigger)<br>Image upload over FTP, e-mail, or HTTP        |  |                 |
| Protocols               | TCP/IP, HTTP, UDP, FTP, ICMP, ARP, DHCP, NTP, RTP, RTSP, RTCP,<br>SMTP, IGMP, ZEROCONF, QoS Layer 3, SNMP   |  |                 |
| Processor/Memory        | Multimedia Video Processor, FPGA, 256 MB RAM, 64 MB Flash   |  |                 |
| Power                   | PoE (Power over Ethernet IEEE 802.3af Class 0) or 12 to 24 VDC<br>Power consumption typ. 5.5 W at 12 VDC (excl. heater)   |  |                 |
| Connectors              | RJ-45 connector for 10/100 BASE-T Ethernet, full or half duplex<br>Push-in terminal for DC power, digital I/O and RS-485/422  |  |                 |
| Operating Conditions    | -40 °C to 50 °C (-40 °F to 122 °F), <90% relative humidity (non-condensing)<br>Starting temperature: -40 °C to 50 °C (-40 °F to 122 °F)   |  |                 |
| Standards               | DIN EN 50130-4, FCC Class A, CE, RoHS, ONVIF  | DIN EN 50130-4, FCC Class B, CE, RoHS, ONVIF   |                 |
| Housing                 | Ø148 mm x 122 mm (Ø5.83" x 4.8") vandal-proof aluminum chassis<br>with polycarbonate dome bubble, IP66  |  |                 |
| Weight                  | -1.0 kg   |  |                 |

Specifications are subject to change without prior notice.

## OTHER INFORMATION

### How Does Basler Ensure Superior Quality and Reliable High Performance?

Our approach to quality assurance is rigorous: we continually audit all facets of our business to guarantee performance, increase efficiency and reduce costs for our customers. We are compliant with all major quality standards including ISO9001, CE, RoHS, ONVIF, and more. To ensure consistently high product quality, we employ several quality inspection procedures during manufacturing.

Every Basler camera is subjected to exhaustive optical and mechanical tests before leaving the factory. We have developed a unique combination of optics, hardware, and software tools that can quickly and efficiently calibrate a camera and measure its performance against a set of standard performance criteria. Regardless of what technology or camera model you choose you can be assured of consistent performance.

### 3-Year Warranty

Basler offers a 3-year warranty for our cameras. We make this unprecedented promise because we have unparalleled confidence in our products. We continually reinvest in research, development and superior manufacturing capabilities so that our customers can fully rely on the products we manufacture.

### About Basler

Founded in 1988, Basler is a leading global manufacturer of high quality digital cameras for industrial, medical, traffic and video surveillance applications. The company employs some 300 people at its headquarters in Ahrensburg, Germany and subsidiaries in the United States and Asia.

Basler's portfolio of products offers customers the vision industry's widest selection of industrial and network cameras. Today it includes some 300 models - and it's still growing. We're committed to developing technology that drives business results for our customers: cameras that are easy to use, easy to integrate, and deliver an exceptional price/performance ratio.



#### Basler AG

##### Germany, Headquarters

Tel. +49 4102 463 500

Fax +49 4102 463 599

[sales.europe@baslerweb.com](mailto:sales.europe@baslerweb.com)

[www.baslerweb.com](http://www.baslerweb.com)

#### USA

Tel. +1 610 280 0171

Fax +1 610 280 7608

[sales.usa@baslerweb.com](mailto:sales.usa@baslerweb.com)

#### Singapore

Tel. +65 6425 0472

Fax +65 6425 0473

[sales.asia@baslerweb.com](mailto:sales.asia@baslerweb.com)

#### Korea

Tel. +82 707 1363 114

Fax +82 707 0162 705

[sales.korea@baslerweb.com](mailto:sales.korea@baslerweb.com)